

Saf-T-Wash™

FOOD SANITIZER INSTRUCTION GUIDE

All Natural

- Chemical free

Helps keep foods free of Pathogens

- The most effective option available

Saves money

- Less food waste
- Eliminates costly chemical veggie washes
- Reduces labor costs



SRKR
E-319375
Commercial Water Sanitizer Unit



Establishment # 068345-WI-001



Federal Register
Vol 66, No. 123, pp 33829-33830



WARNING

Before installation and use,
read this manual and all instruction
sheets included with your unit.

SAN JAMAR

Smart ▶ Safe ▶ Sanitary



Reduce risk. Save money.

Saf-T-Wash™ Food Sanitizer dramatically extends the shelf life of produce, reducing prep frequency and produce waste.

TABLE OF CONTENTS

5-6	Before You Get Stared: Key Information & Safety Precautions
7	Required Operating Conditions & Specifications
8-9	Product Overview
10-12	Installation Instructions
13-15	Operating Instructions
16	Cleaning and Maintenance
17-18	Trouble Shooting
19	Introduction to Saf-T-Wash™ and Ozone Sanitizing Technology
20-21	Frequently Asked Questions about Saf-T-Wash™ and Ozone Technology
22	Saf-T-Wash™ and Safe Food Handling
23	Notes
24	Warranty



Saf-T-Wash™

Saf-T-Wash™ FOOD SANITIZING SYSTEM

Thank you for choosing San Jamar's Saf-T-Wash™ Food Sanitizing System. You have purchased one of the most leading edge, eco-friendly sanitizing systems on the market today. When installed, maintained and used properly, we're confident you will enjoy years of outstanding benefits to your operation. Please take a few moments to fill in the information below.

MODEL
STW1200



WARNING

Be sure to retain this information and instruction manual for training & future reference.

RETAIN KEY PRODUCT INFORMATION

Date of Purchase:	
Purchased From:	
Phone Number:	
Serial Number:	
Installed by:	
Dealer Name:	

IMPORTANT SAFETY INFORMATION

SAF-T-WASH™ FOOD SANITIZER has been engineered for trouble-free performance in a wide variety of applications and environments. However, like most products, specific operating specifications must be ensured to ensure consistent, safe use. Before beginning installation and use, it is mandatory that the following conditions and cautions be met. Failure to ensure the proper operating specifications and conditions or to use only the included Saf-T-Wash™ parts and accessories will compromise unit performance, void the warranty and could cause injury or electric shock.

AVOID WATER OR EXCESSIVE MOISTURE CONTACT WITH SAF-T-WASH™ UNIT

Failure to prevent excessive moisture, splashing or submerging of unit could cause product failure, injury or death. Do not allow moisture to come in contact with any internal or external electronic components. Should a leak occur immediately shut off the cold water supply adapter, unplug wall transformer and contact your dealer for service.

 WARNING
Failure to comply with these guidelines will compromise unit performance, void the warranty and may cause injury or electric shock.

- Saf-T-Wash™ may only be powered through a GFI protected electrical outlet.
- This unit should only be operated from the type of wall transformer power source provided. If you are not sure of the type of power supply, consult your Saf-T-Wash™ Dealer or San Jamar Customer Care.
- Power supply cords must be routed so that they will not be walked on or pinched by items placed upon or against them.
- **DO NOT** use extension cords. Always consult local electrical codes.
- Use only Saf-T-Wash™ authorized components and accessories.
- **DO NOT** attempt to open the unit.

CONTINUED ON NEXT PAGE

IMPORTANT SAFETY INFORMATION CONTINUED

FOLLOW PROPER WATER PRE-FILTRATION SPECIFICATIONS

To ensure optimum performance, long life and effective sanitizing, the water going into the Saf-T-Wash™ unit must be filtered to eliminate chlorine, sediment and other factors which will reduce the sanitizing effectiveness of Saf-T-Wash™. *Review pg. 14 for required filtration specifications, how to test effectiveness of your filter and installation with Saf-T-Wash™.*

FOLLOW MINIMUM OPERATING CONDITIONS BEFORE INSTALLATION

Extreme environmental conditions may reduce the effectiveness of Saf-T-Wash™ and must be monitored and avoided. *Review pg. 7 for required minimum operating conditions before beginning installation of Saf-T-Wash™.*

FOLLOW PROPER INSTALLATION & OPERATION PROCEDURES

Proper installation and operation are critical to ensure effective, safe operation of Saf-T-Wash™. *Review pgs. 5-16 to ensure your Saf-T-Wash™ system is properly installed and that all users are properly trained on correct operating procedures.*

REQUIRED OPERATING CONDITIONS & SPECIFICATIONS

The following environmental/operational requirements are critical to ensure proper performance and long life of the Saf-T-Wash™ Food Sanitizing System. These factors, alone or in combination, may reduce the level of ozone in the water, reducing the effectiveness of Saf-T-Wash™. It is important to work with your facilities manager, installer or equipment dealer to ensure all operating conditions are met. Always use Saf-T-Wash™ Ozone Test Strips to ensure proper use before installation and at least weekly thereafter. See *pgs. 14-15 for detail instructions on Test Strip procedures.*

WATER PRESSURE

The Saf-T-Wash™ works best at water pressures greater than 40 psi and no more than 65 PSI.

WATER TEMPERATURE

The Saf-T-Wash™ Sanitizer is designed for optimum performance at water temperatures above 40°F (4°C) and below 72°F (22°C). Colder water results in higher efficiency of the Saf-T-Wash™ Ozone Technology. Temperatures above 90°F (32°C) are to be avoided because they can limit the residual lifespan of the ozone.

PRE-FILTRATION

Any water treatment systems, such as softeners, or in-line filtration systems installed prior to the Saf-T-Wash™ Food Sanitizer should be maintained and in good working condition. Failure to do so will inhibit the functionality of the Saf-T-Wash™ unit. In addition, water used with Saf-T-Wash™ must be filtered to remove chlorine, sediment and other organics.

Options for filtration are:

1. San Jamar's STW1200KIT Filtration Kit
2. Alternative filtration system

If you chose an alternative filtration system, test the water to make sure it meets minimum operating conditions. See *pg. 14 for water testing procedure and filtration requirements.*

AIR TEMPERATURE

The Saf-T-Wash™ Sanitizer is designed to work at air temperatures below 88°F (31°C) for optimum performance.

DEW POINT & RELATIVE HUMIDITY

The Saf-T-Wash™ Sanitizer works best at a dew point of below 75°F (24°C) and below 65% relative humidity.

MINIMUM WATER QUALITY STANDARDS

Water quality must meet or exceed minimum EPA standards for municipal water including a maximum presence of 0.1 PPM of iron or manganese.

VENTILATION

Minimum 4 air exchanges per hour (industry standard).

Saf-T-Wash™

PRODUCT OVERVIEW

Your Saf-T-Wash™ Food Sanitizing System includes the following components. Before installation, be sure you have all of the necessary elements. Contact your dealer for replacement of any missing or damaged components.



Also included

(not pictured):

- Instruction Manual
- Job Aid Poster



PRODUCT OVERVIEW

It is important for you to be familiar with certain components elements of Saf-T-Wash™ to ensure proper operation and troubleshooting.



INSTALLATION INSTRUCTIONS

WARNING

Before installation, ensure proper safety precautions are met (pg. 6), required filtration is installed (pg. 14) and required operating conditions are met (pg. 9). Read all installation instructions before beginning installation.

The installation instructions contain three sections:

Section 1: Saf-T-Wash™ Unit Installation

Section 2: Filter Kit Assembly

Section 3: Connecting the Unit to the Filter

If you are NOT using the STW1200KIT filter kit, then disregard Section 2 and go right from Section 1 to Section 3. However, it is important to determine that your filter kit is working adequately to ensure the full effectiveness of the Saf-T-Wash™ Unit. See pgs. 14-15 for water testing procedures.

SECTION 1: Saf-T-Wash™ Unit Installation

STEP 1: Locate an area on the wall above a prep sink or 3-compartment sink:

- Check that the electrical cord will reach from the Saf-T-Wash™ unit to a GFI Protected electrical outlet.
- Make sure the diverter valve hoses will reach from the unit to the aerator of the faucet and allow adequate movement of the faucet arm.
- Ensure the selected position for mounting is away from potential water splashing or spraying the unit.
- Measure for proper wall space to install Saf-T-Wash™ unit **AND** filtration kit.

STEP 2: Attach the provided mounting plate to the wall at the chosen location using a Phillips screw driver and the provided screws. There are two screws and two mounting holes.

STEP 3: Locate the mounting holes on the back of the Saf-T-Wash™ unit. It is essential that you install the unit horizontally right side up.

STEP 4: Mount the unit to the back plate by lining up the mounting holes on the top rim to the silver hanging screws attached to the mounting plate.

STEP 5: Your kitchen faucet should have a threaded attachment containing a screen. Unscrew the attachment and put it aside for possible later use.

NOTICE: Your faucet may require an adaptor to allow connection with the Diverter-Valve Assembly based on threading. Check the connection and select one of the aerator adaptors included if needed.



Note the sticker labeled "UP" to ensure proper hanging.





STEP 6: Thread the Diverter Valve Assembly onto your kitchen faucet. The hose connections should be toward the rear of your faucet.

STEP 7: Tighten the Diverter Thread Attachment. (Use pliers to tighten to prevent leaking. Do not tighten so hard as to strip the threads.)

SECTION 2: STWI200KIT Filter Kit Installation

(skip to **Section 3** if you already have a proper filter kit installed)

Your **STWI200KIT** Filtration Kit includes:

- filter house unit and filter
- teflon tape
- (1) 14" grey tube
- (2) mounting screws
- (2) 3/8" threading adapters

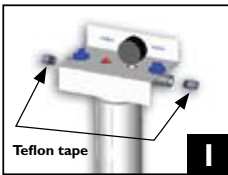

STEP 1: Apply 4 complete wraps of Teflon tape (included) to the threaded fitting before assembling them onto the filter housing (see "Filter Kit Start-Up" on pg. 2 in the *Saf-T-Wash™ Filter Kit Installation and Operation Guide* included in your STWI200KIT filtration kit for cartridge installation instructions).

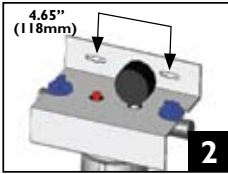

STEP 2: Mount filter unit to the wall.

STEP 3: Separate blue and grey tubes about 30" from the end of Valve Assembly. Using scissors, cut 24" off of grey tube.

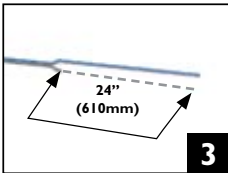

STEP 4: Mark the grey tube 3/4" from the end. Plug grey tube into the inlet of the filter housing (labeled "inlet") to the 3/4" mark. **IT IS IMPORTANT** to make sure the grey tube is plugged in all the way to avoid a water leak. The blue tube will run past the filter. It runs from Saf-T-Wash™ unit to the diverter valve.



STEP 5: Take the 14" grey tubing piece (included in kit), mark 3/4" from the end, and plug into the outlet of the filter assembly, inserting fully to the 3/4".

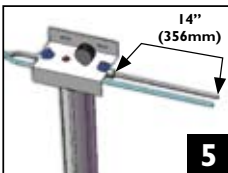

SECTION 3: Connecting the Unit & Filter Kit



STEP 1: Remove the blue clip on Saf-T-Wash™ Unit and insert the blue Return Line into the Water Outlet filter (labeled “outlet”). Make sure ¾” of tubing is inserted into the outlet. Replace blue clip. Make sure tube is inserted ¾” to avoid leakage.



STEP 2: Remove the red clip and insert the grey Supply Line into the Water Inlet filter on the side of the Saf-T-Wash™ unit. Make sure ¾” of tubing is inserted into the inlet. Replace red clip. Make sure tube is inserted ¾” to avoid leakage.

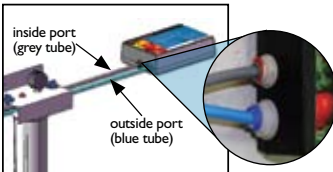

NOTICE: The Quick Connect fitting requires insertion of hoses followed with a quick tug to ensure the tubing is correctly engaged.

STEP 3: It is recommended that you use some wire ties to hold the Diverter Valve Assembly hose in place along the stem of the faucet to keep it secured and out of the way.



STEP 4: Plug the end of the Wall Power Supply into the Power Jack on the Saf-T-Wash™ unit. Turn the threaded fitting until the threads catch and tighten.

STEP 5: It is recommended that you use wire ties to hold into place the Wall Power Supply electrical line along the wall to the power outlet (Must be GFI Protected Electrical Outlet). Plug the Wall Power Supply into the outlet. The Main Power green indicator light will turn on letting you know that your Saf-T-Wash™ has electricity available for operation.



GFI Outlet

WARNING! If you turn on your Saf-T-Wash™ and the red alarm indicator light (see pg. 9 for light location) turns on with a continuous buzzer, this mean that your product has a malfunction. Do not attempt to use this product. Unplug the power cord from the wall and contact your dealer or San Jamar.

OPERATING INSTRUCTIONS

DISPENSING OZONATED WATER

NOTICE: Use **COLD WATER ONLY**. Hot or warm water will reduce the amount of time the ozone is retained in the water and reduce overall performance.

STEP 1: Turn on your faucet, (cold water only to ensure maximum ozone effectiveness).

NOTICE: Before first use, verify proper filtration by following step one in the test strip instructions on pg. 15.

STEP 2: If your test strips indicate proper filtration while running the cold water, to begin dispensing ozonated water, rotate the diverter valve handle up to initialize Saf-T-Wash™. Saf-T-Wash™ will automatically turn on as the water flows through the newly installed diverter valve. You will see the **Blue Sanitizing Indicator Light** illuminate when the diverter valve is opened (see pg. 9 to identify light).

NOTICE: If the blue light does not turn on, please review the trouble shooting directions on pg. 17 or contact your dealer or San Jamar Customer Care.

STEP 3: Fill container with sanitizing water and immerse foods. Rinse foods under running sanitizing water as described below.

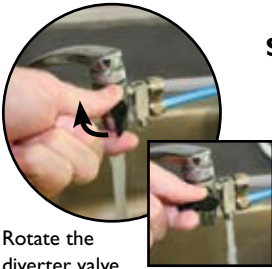

Rotate the diverter valve handle up.



LEAFY PRODUCE



Expose all surfaces to the sanitizing water. Rub gently with hands to remove dirt.

SOFT SKINNED FOODS



Place in a container and flood the surfaces as you rub gently for at least 30 seconds.

HARD SKINNED FOODS



For hard skinned foods, use a stiff bristled brush. Rinse for at least 30 seconds.

ENSURING PROPER USE & EFFECTIVENESS

FILTRATION

Minimum filtration requirements:

- 1 micron Carbon Block Filtration
- Chlorine elimination

Options for filtration are:

1. San Jamar's STW1200KIT Filtration Kit
2. Alternative filtration system

If you chose an alternative filtration system, test the water to make sure it meets minimum operating conditions (see "Testing Alternative Filtration Systems" below).

San Jamar offers an optional Filter Kit (STW1200KIT) that includes a 20,000 gallon filter assembly including a gauge that shows filter cartridge life.

Replacement filters are also available (STW1200FIL). See pg. 11 for proper Filtration Assembly Installation.

The optional Saf-T-Wash™ filter kit includes a filter head, cartridge and filter monitor. The filter is rated for 20,000 gallons. If the supplied water has high levels of sediment, calcium, lime and/or chlorine, the life of the filter will decrease as with all filters.

It is critical that the filter is replaced when:

- PPM level testing shows levels below .15 PPM.
- The filter monitor indicates replacement is needed.
- The water flow is reduced significantly, indicating a blocked filter.



NOTICE: Whenever testing for chlorine or ozone it is important to understand that this is a two-step process. To ensure peak product performance make sure your filter is removing chlorine from the water and the ozone PPM level is in the acceptable range.

ONE: TESTING FOR CHLORINE IN WATER

Before beginning Saf-T-Wash™ installation, it is important to ensure that all traces of chlorine have been removed from the water. One option is San Jamar's STW1200KIT filter kit. If you have the STW1200KIT or an alternative filtration system, it is important to check the water to ensure Saf-T-Wash™ will function correctly. To test the water coming out of an alternative filtration system you will need a small container and the test strips included with the Saf-T-Wash™ unit.

STEP 1: Unplug Saf-T-Wash™ Unit. Run water.

STEP 2: Open one individually wrapped test strip.

STEP 3: Fill a small container (about 8 oz.) with filtered water and immediately dip test strip into water with a constant back and forth motion for 10 seconds.

STEP 4: Remove the strip from the water; shake once briskly to remove excess water. Wait 20 seconds.

STEP 5: Match the color of the strip to the scale. If the strips show 0.1 to 0.5 PPM, then chlorine is present. This indicates that the alternative filtration system is not removing chlorine from the water and the Saf-T-Wash™ unit will not work effectively.

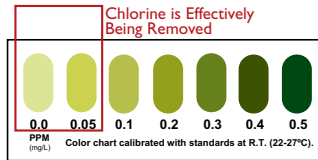

TWO: USING TEST STRIPS WITH SAF-T-WASH™ ENSURING PROPER PPM LEVELS

To ensure proper and safe use, it is critical to verify parts per million (PPM) of ozone in the water for sanitizing effectiveness. Proper operating range is between .15 and .5 PPM. Test strips should be used at least once per week during normal operation, but **MUST** also be used at these times:

- As part of first start-up
- After replacing the filter
- After moving the unit
- After not using the unit for one week
- After any electrical current change, such as blow breaker
- After any exposure to water or abuse

NOTICE: Use *ONLY* Sensafe Brand Ozone Test strips (item number 481134) distributed by San Jamar. No other test strips will work with these instructions.



3

STEP 1: **Test water for chlorine first (see pg. 14).** Run Saf-T-Wash™ unit for 15 seconds. (be sure to plug-in your Saf-T-Wash™ unit).

STEP 2: Open one individually wrapped test strip.

STEP 3: Fill a small container (about 8 oz.) with sanitized water and immediately dip test strip into water with a constant back and forth motion for 10 seconds.

STEP 4: Remove the strip from the water; shake once briskly to remove excess water. Wait 20 seconds.



5

STEP 5: Match the color of the strip to the scale to verify proper PPM level (.15 to .5). If levels are below or above this range, repeat STEPS 1-6, then review Trouble Shooting instructions on pgs. 17-18.

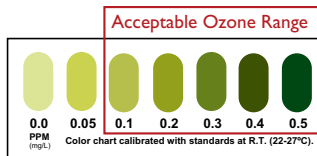

CLEANING & MAINTENANCE

Your Saf-T-Wash™ is virtually maintenance free. Please follow the procedures below to maintain the performance.

- Unplug Saf-T-Wash™ Power Supply before performing any cleaning or maintenance.
- Read the entire instruction manual and job aids and ensure crew is properly trained on all procedures and precautions before use.
- Proper filtration is critical.
 - Monitoring filter life and ensuring effectiveness with test strips is key to preventing sediment and chemicals from causing long-term damage to your Saf-T-Wash™ unit.
 - Change any pre-filters that have been installed on the water supply during initial installation of Saf-T-Wash™.
 - Flush any new filters for approximately three minutes to flush out carbon fines before using Saf-T-Wash™.

CLEANING

- Never attempt to open the Saf-T-Wash™ unit for any reason.
- If the exterior case of the unit becomes soiled, disconnect the power supply and wipe down with damp cloth and light detergent. Avoid any water from entering the Saf-T-Wash™ unit.

WARNING

Avoid excessive moisture, splashing or submerging of unit. This could cause product failure, impair product effectiveness, void warranty, injury or electric shock.

TROUBLE SHOOTING

Your Saf-T-Wash™ unit has been engineered for trouble-free long life. However, if you experience any performance issues, please review the corrective actions below. If these solutions do not resolve the problem, please call San Jamar Customer Care at 800-248-9826 or 262-723-6133 for further support. Do not operate Saf-T-Wash™ if the **Red Alarm Light** is on OR if the **Blue Sanitizing Light** is not flashing when the diverter valve is in the ON position.



1. The **Green Main Power Indicator Light** does not come on when plugged in.
 - Make sure Power Supply connection to the Saf-T-Wash™ is fully inserted and screwed into place.
 - Make sure the plug is fully inserted into the wall.
 - Make sure the breaker on the GFI outlet or breaker box has not been tripped. If so, reset the breaker.

2. Water is leaking out of the “inlet” and/or “outlet” ports on the Saf-T-Wash™ unit.
 - Check to make sure the blue and/or grey tube(s) is/are inserted $\frac{3}{4}$ ” into ports.
 - Remove tube(s) and re-insert. To remove tube(s), remove red and/or blue clip on port. Push back the Quick Connect fitting so it touches the port. Pull out tube. To reinsert, see Steps 1 & 2 on pg. 12.
 - If problem persists, call San Jamar Customer Care.



Make sure tubes are inserted $\frac{3}{4}$ ” into ports.

TROUBLESHOOTING CONTINUED ON NEXT PAGE

3. The flashing **Blue Sanitizing Indicator Light** does not come on when diverter valve is in the ON position.
 - Make sure that the valve is completely open.
 - Verify that the **Green Power Light** is on (if it is not, refer to the corrective actions in #1 above).
4. The **Red Alarm Light** is on and/or an alarm signal is sounding.
 - Disconnect the unit immediately and contact your Dealer or San Jamar Customer Care.
5. Test Strips show ozone below .15 PPM.
 - Make sure you have proper filtration (see pg. 14 for filtration requirements).
 - Ensure you are using only individually wrapped Sansafe Brand Ozone Test Strips.
TEST IMMEDIATELY AFTER OPENING.
 - Make sure to follow the correct Testing Procedures (see pg. 15 and the Saf-T-Wash™ Job Aid).
 - Ensure you are using cold water only (below 72°F [22°C]).
 - Verify the environment is within minimum operating conditions (see pg. 7).
 - Check that the **Green Main Power Indicator Light** is on (if not, follow the directions in #1 above).
 - Ensure the **Blue Sanitizing Indicator Light** is flashing and that the diverter valve is turned completely in the on position (if not, follow the directions in #2 above).
 - Replace the filter cartridge.
6. The water flow rate has decreased significantly.
 - The filter may be blocked with sediment.
Replace filter cartridge.

**SAF-T-WASH™
AND OZONE
SANITIZING
TECHNOLOGY**

Ozone Technology has been used for many years in many industries such as water purification and food processing. In fact, most bottled water you drink has probably been sanitized using Ozone Technology. San Jamar's Saf-T-Wash™ takes this powerful and effective technology and packages it in the right size and scale for commercial foodservice use.



Rinsed with ordinary tap water

Ozone is the most powerful bactericide commonly available for purification purposes. It is effective against a wide range of bacteria and viruses including those that are resistant to less powerful chemical additives, such as chlorine. Ozone is the only substance that can be added to water that can be called a “purifier” because it reverts to oxygen very rapidly, leaving no ozone residue.



Rinsed with ozonated water (0.3 ppm)

Ozone rinsing of foods and surfaces, even at low ozone levels, has been shown to be effective in minimizing microbiological contamination and reducing exposure to food-borne pathogens. All sanitizers require some contact time with the contaminated surface to be optimally effective. Ozone contact time is shorter than any other disinfectant.

Both photos are day 7 after being rinsed and refrigerated in a sealed container.

By rinsing surfaces with cold, ozonated water, bacteria and viruses, can be reduced significantly. Ozone will not purify what it cannot reach, but flooding contaminated surfaces with Ozonated water will greatly impact the viability of any microbiological contaminant and provide a level of protection otherwise unavailable.

By reducing or eliminating bacterial contamination of foods and surfaces, the devastating consequences of human pathogen exposure are greatly reduced. Extended shelf storage life of produce and related food items exposed to ozone has been documented.

FREQUENTLY ASKED QUESTIONS



1. WHAT ARE THE MOST IMPORTANT BENEFITS OF THE SAF-T-WASH™ UNIT?

Saf-T-Wash™ is designed to benefit foodservice operations in three primary ways:

1. Food sanitizing rinse to help minimize exposure to microbiological contamination of fruits, vegetables, produce and meats.
2. Rinsing the surfaces of fruits and vegetables has been shown to extend the shelf life of such foods by reducing the levels of many microorganisms and enzymes that cause food spoilage. The ozone leaves no chemical residual on such surfaces because it reverts to its original oxygen form very quickly.
3. Provides a safe, natural, environmentally friendly alternative to hazardous chemical washes.

2. WHAT IS OZONE?

Ozone is a natural form of oxygen, but with important differences. Unlike the stable oxygen we breath (O_2), Ozone (O_3) has a third oxygen atom bound to it through an electrical discharge; in nature this occurs from lightning in our atmosphere. Ozone is a highly reactive form of oxygen because the third oxygen atom is very loosely bound with the other two oxygen atoms. The unstable oxygen atom can't stabilize until it finds something to form with to become a stable molecule. Bacteria on the surface of food, for example, absorb these O_3 molecules which, due to their instability, very quickly break apart – literally exploding the bacteria. Although Ozone occurs in nature, it is only able to be produced on demand by an Ozone Generator creating the electric charge that binds the three oxygen atoms together.

3. HOW DOES THIS RELATE TO THE “OZONE LAYER?”

The “Ozone Layer” is the stratosphere that is part of the Earth's atmosphere. The stratospheric “ozone layer” extends from approximately six to thirty miles above the Earth's surface and reduces the amount of harmful UV radiation reaching the Earth's surface. This is why we hear about the importance of protecting the ozone layer. Down on earth, Ozone can form from the reaction of

pollutants and emissions (volatile organic compounds and nitrogen oxides) with sunlight and heat. This form of Ozone is what our society is trying to control by reducing auto, chemical and gasoline emissions.

4. IS THE OZONE CREATED BY SAF-T-WASH™ SAFE?

Yes. Saf-T-Wash™ uses an electrical charge to create Ozone and dissolve it into water for sanitizing. After the ozone has effectively destroyed dangerous bacteria on foods, it immediately reverts to pure oxygen and water, safe for the environment and humans. The very low level of ozone Saf-T-Wash™ generates in the water (.15 to .5 parts per million) with only a small fraction being released into the air ensures safe use within established EPA and OSHA standards in a kitchen environment with normal ventilation.

5. IS THE OZONE SANITIZED WATER SAFE TO DRINK?

Yes. Because of the rapid return to oxygen that occurs when the ozonated water is consumed, little or no ozone is actually ingested.

6. CAN SAF-T-WASH™ BE USED FOR SANITIZING SURFACES?

Yes, however the Saf-T-Wash™ unit is designed as a sanitizing rinse. It is necessary to wash items such as dishes, cutting boards, meat trays, kitchen sponges, etc. to remove coarse particles, oils and grease as you do normally, and then rinse them to remove the soap. Place the item under the cold water ozone rinse from the Saf-T-Wash™ for at least 30 to 60 seconds. It is important that the ozonated water flood over every part of the exposed surfaces.

7. HOW IS SAF-T-WASH™ USED FOR SANITIZING FOODS?

Generally, the most effective method is to soak foods in a bowl or pan of ozonated water, then rinse and agitate under flowing ozonated water. It is recommended that the item be rubbed with the hands to make sure all dirt is scrubbed away and all surfaces are contacted thoroughly. *Please read operating instructions on pg. 17 and the Saf-T-Wash™ Instruction Guide for specific procedures.*

8. CAN SAF-T-WASH™ WATER BE USED FOR SANITIZING HANDS?

Yes. Ozone is a powerful eliminator of Staph and other germs common to the human skin surface. However, it is important that hands are first washed with warm soap and water, rinsed with warm water to remove the soap, then rinsed thoroughly for at least one minute with the ozonated water. The longer the ozone rinse, the greater the reduction in skin-borne microorganisms.

9. WHAT EFFECT DOES PDS (PARTIALLY DISSOLVED SOLIDS) HAVE ON OZONE ?

Saf-T-Wash™ has been tested to be effective at minimum EPA water quality standards which includes a maximum of 500 mg/L of PDS. Saf-T-Wash™ will still deliver effective PPM and sanitizing ability with water containing high levels of PDS, but San Jamar recommends you test the PPM level Saf-T-Wash™ delivers using the specific water supply by following our test strip procedure to verify that the unit is delivering effective ozone level of .15 to .5 PPM.

SAF-T-WASH™ & SAFE FOOD HANDLING For safest results and effectiveness, it is important to observe Food Safety best practices as part of Saf-T-Wash™ operation.

1. Washing your hands frequently is an easy way to keep microorganisms from spreading. Rinsing your hands under the Saf-T-Wash™ repeatedly while preparing food will also help from spreading the germs.
2. Ensure all food containers and utensils are washed, rinsed and sanitized. Rinsing these cleaned items prior to use in Saf-T-Wash™ water is another way to ensure proper sanitation.
3. Clean and sanitize all work surfaces and cutting boards before, after and throughout food preparation.
4. Rinsing meats and other foods prior to cooking with the Saf-T-Wash™ will reduce pathogens that otherwise may cause foodborne illnesses. Thorough cooking of chopped, ground or mixed foods (ex. ground meat or casseroles) to recommended internal temperatures will help ensure safety.

SAF-T-WASH™ LIMITED THREE YEAR WARRANTY

San Jamar (meaning The Colman Group, Inc., San Jamar Division, or San Jamar Europe, Inc., as applicable) warrants to the original purchaser of each new product of its manufacturer for a period of three (3) years from the date of shipment that all parts shall be free from defects in material and workmanship under normal use and service.

The warranty defined herein shall not apply to any damage or defects created or arising from accident, misapplication, abuse, misuse, neglect, alteration, acts of God, vandalism, flood, fire or any other occurrences beyond the control of San Jamar.

Claims under the foregoing warranty will be honored only if San Jamar (i) has received the entire payment of the purchase price for the product with respect to which any such claim is made, (ii) has received notification of the claim prior to the expiration of the three (3) years (or shorter) warranty period described above, and (iii) determines upon examination of the returned product that it is defective under the terms of such warranty.

San Jamar's sole obligation under the foregoing warranty and for other claims related to any product shall be limited to, at San Jamar's option, (i) repairing or (ii) replacing, F.O.B. Factory, any product which San Jamar determines is defective under the terms of such warranty.

THE FOREGOING WARRANTY AND REMEDIES ARE EXCLUSIVE AND IN LIEU OF ANY OTHER WARRANTIES AND REMEDIES WHATSOEVER, EXPRESSED OR IMPLIED, INCLUDING BUT NOT LIMITED TO ANY IMPLIED WARRANTIES OF MERCHANTABILITY OR FITNESS FOR A PARTICULAR PURPOSE, ALL OF WHICH SAN JAMAR HEREBY EXPRESSLY DISCLAIMS.

SAN JAMAR
Smart ♦ Safe ♦ Sanitary

555 Koopman Lane
Elkhorn, Wisconsin 53121 USA
T: (262) 723-6133 F: (262) 723-4204
Customer Care: (800) 248-9826
Email: sanjamar@sanjamar.com
www.sanjamar.com

SAN JAMAR EUROPE, INC.
Schoorstraat 26A, Bus 1
B-2220 Heist op-den Berg
BELGIUM
T: +32 15 228140 F: +32 15 228148
E-Mail: sjeurope@sanjamar.com

SAN JAMAR Mexico, S de RL de CV
Prolongación Av. San Antonio
No. 135 col. San Pedros de los Pinos
C.P. 01180 en México, DF
MEXICO
T: +52 (55) 3626 0772
F: +52 (55) 5273 4495
sjmexico@sanjamar.com